

C.I.P.**8 mm Lebel**

TAB. IV

Date 84-06-14

Pays d'origine: FR

Révision 00-06-07

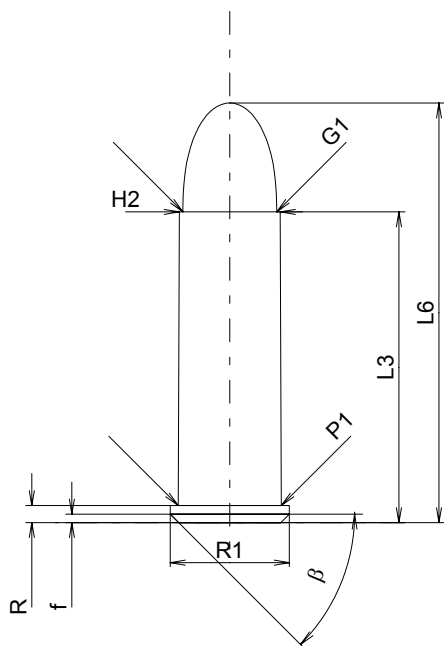
**CARTOUCHE MAXI****Longueurs**

L1	=	
L2	=	
L3 ¹⁾	=	27.40
L4	=	32.00
L5	=	
L6	=	37.00

Culot

R ¹⁾	=	1.50	-0.25
R1	=	10.50	
R3	=		
E	=		
E1	=		
e min	=		
δ	=		
f	=	0.75	
β	=	45°	

Chambre à poudre

P1	=	9.10
P2	=	

Cône de raccordement

α	=	
S	=	
r1 min	=	
r2	=	

Collet

H1	=	
H2 ¹⁾	=	8.90

Projectile

G1 ¹⁾	=	8.28
G2	=	
F	=	
L3+G ¹⁾	=	29.90

Pressions (Énergies)**Méthode transducteur**

Pmax	=	1250 bar
PK	=	1438 bar
PE	=	1625 bar
M	=	12.50

Autres indications

Fe ¹⁾	=	0.25
delta L	=	

CHAMBRE MINI**Longueurs**

L1	=	
L2	=	
L3 ¹⁾	=	27.50

Cuvette

R ¹⁾	=	1.50
R1	=	10.60
R2	=	
R3	=	
r	=	

Chambre à poudre

E	=	
P1 ¹⁾	=	9.20
P2	=	

Cône de raccordement

α	=	
S	=	
r1 max	=	
r2	=	

Collet

H1	=	
H2 ¹⁾	=	8.95

Prise de rayures

G1 ^{1)*}	=	8.35
G ^{1)*}	=	2.50
α1	=	62°
h*	=	0.50
s	=	
i ¹⁾	=	5°
w	=	

Canon

F ^{1)*}	=	8.00
Z ¹⁾	=	8.30

Rayures

b	=	4.19
N	=	4
u	=	240.00
Q	=	52.91 mm ²

Échelle 1.5:1

Dimensions en << mm >>
Dimensions et tolérances pour les canons
d'épreuve: Voyez Annexe CR 1.

Notes: 1) A' contrôler pour la sécurité
* Dimensions de base