

C.I.P.**8 mm Gasser**

TAB. IV

Date 84-06-14

Pays d'origine: AT

Révision 00-06-07

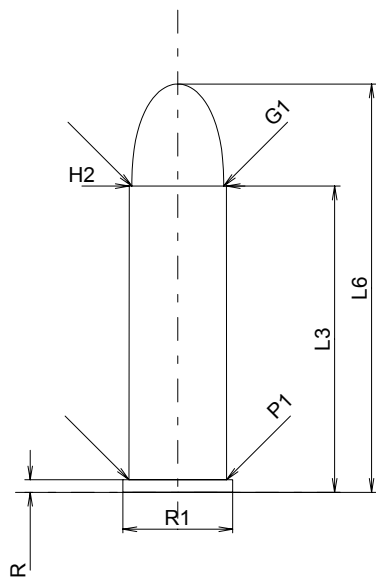
**CARTOUCHE MAXI****Longueurs**

L1	=	
L2	=	
L3 ¹⁾	=	27.00
L4	=	
L5	=	
L6	=	36.00

Colot

R ¹⁾	=	1.10	-0.25
R1	=	9.68	
R3	=		
E	=		
E1	=		
e min	=		
δ	=		
f	=		
β	=		

Chambre à poudre

P1	=	8.60
P2	=	

Cône de raccordement

α	=	
S	=	
r1 min	=	
r2	=	

Collet

H1	=	
H2 ¹⁾	=	8.56

Projectile

G1 ¹⁾	=	8.11
G2	=	
F	=	
L3+G ¹⁾	=	27.99

Pressions (Énergies)**Méthode transducteur**

Pmax	=	1000 bar
PK	=	1150 bar
PE	=	1300 bar
M	=	12.50

Autres indications

Fe ¹⁾	=	0.25
delta L	=	

CHAMBRE MINI**Longueurs**

L1	=	
L2	=	
L3 ¹⁾	=	27.50

Cuvette

R ¹⁾	=	1.10
R1	=	9.75
R2	=	
R3	=	
r	=	

Chambre à poudre

E	=	
P1 ¹⁾	=	8.64
P2	=	

Cône de raccordement

α	=	
S	=	
r1 max	=	
r2	=	

Collet

H1	=	
H2 ¹⁾	=	8.60

Prise de rayures

G1 ^{1)*}	=	8.08
G ^{1)*}	=	0.99
α1	=	90°
h*	=	0.26
s	=	
i ¹⁾	=	8°57'09"
w	=	

Canon

F ^{1)*}	=	7.85
Z ¹⁾	=	8.05

Rayures

b	=	3.00
N	=	6
u	=	150.00
Q	=	50.24 mm ²

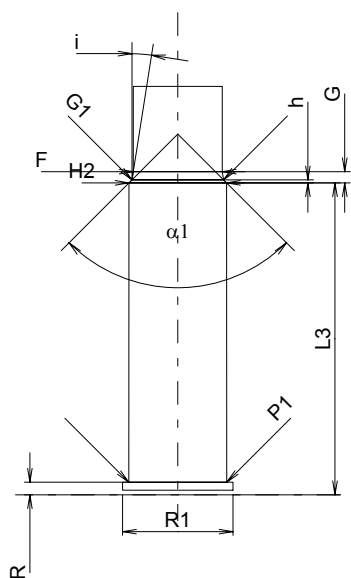

Échelle 1.5:1

Dimensions en << mm >>
Dimensions et tolérances pour les canons
d'épreuve: Voyez Annexe CR 1.

Notes: 1) A' contrôler pour la sécurité
* Dimensions de base