

C.I.P.**7 mm Rosé**

TAB.

III

Date

17-05-17

Pays d'origine: IT

Révision

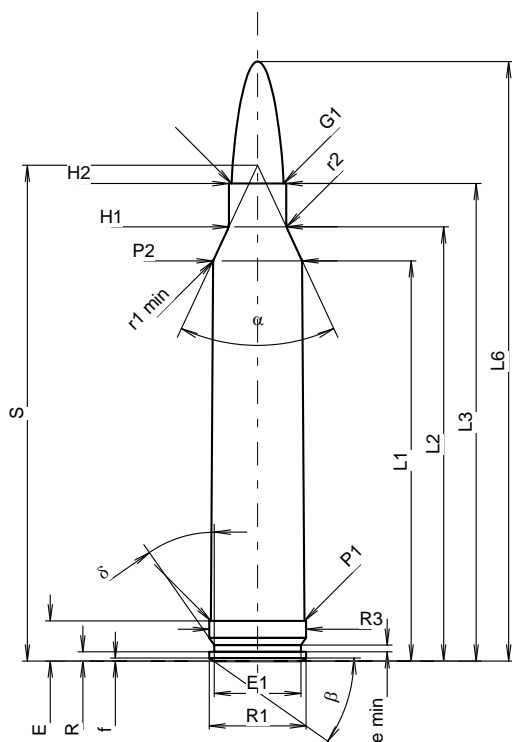
**CARTOUCHE MAXI****Longueurs**

L1	=	55.78
L2	=	60.52
L3 ¹⁾	=	66.55
L4	=	
L5	=	
L6	=	83.57

Culot

R	=	1.27
R1	=	13.51
R3	=	13.51
E ¹⁾	=	5.59
E1	=	12.07
e min	=	0.94
delta	=	35°
f	=	0.41
beta	=	35°

Chambre à poudre

P1	=	13.03
P2 *	=	12.42

Cône de raccordement

alpha *	=	50°
S *	=	69.10
r1 min	=	1.02
r2	=	2.54

Collet

H1 *	=	8.00
H2 ¹⁾ *	=	8.00

Projectile

G1 ¹⁾	=	7.22
G2	=	68.61
F	=	
L3+G ¹⁾	=	72.56

Pressions (Énergies)**Méthode transducteur**

Pmax	=	4300 bar
PK	=	4945 bar
PE	=	5375 bar
M	=	25.00
EE	=	5000 Joule

Autres indications

Fe ¹⁾⁵⁾	=	0.10
delta L	=	

CHAMBRE MINI**Longueurs**

L1	=	55.96
L2	=	60.62
L3 ¹⁾	=	67.16

Cuvette

R	=	1.27
R1	=	13.59
R2	=	
R3	=	13.59
r	=	

Chambre à poudre

E ¹⁾	=	5.59
P1 ¹⁾	=	13.06
P2 *	=	12.45

Cône de raccordement

alpha ¹⁾ *	=	50°
S *	=	69.30
r1 max	=	0.76
r2	=	3.18

Collet

H1 *	=	8.10
H2 ¹⁾	=	8.08

Prise de rayures

G1 ¹⁾ *	=	7.23
G ¹⁾	=	6.01
alpha l	=	90°
h	=	0.43
s *	=	2.50
i ¹⁾ *	=	1°33'01"
w	=	

Canon

F ¹⁾ *	=	7.04
Z ¹⁾	=	7.21

Rayures

b	=	2.79
N	=	6
u	=	241.00
Q	=	40.39 mm ²

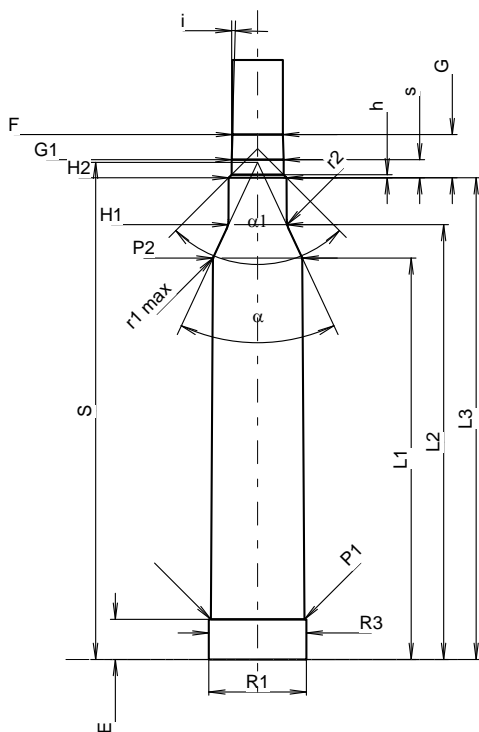

Échelle 1:1.05

Dimensions en << mm >>
Dimensions et tolérances pour les canons
d'épreuve: Voyez Annexe CR 1.

Notes: 1) A' contrôler pour la sécurité
5) Feuillure sur la culot magnum
* Dimensions de base