

C.I.P.**465 H&H Belt. Mag.**

TAB. III

Date 06-09-19

Pays d'origine: GB

Révision

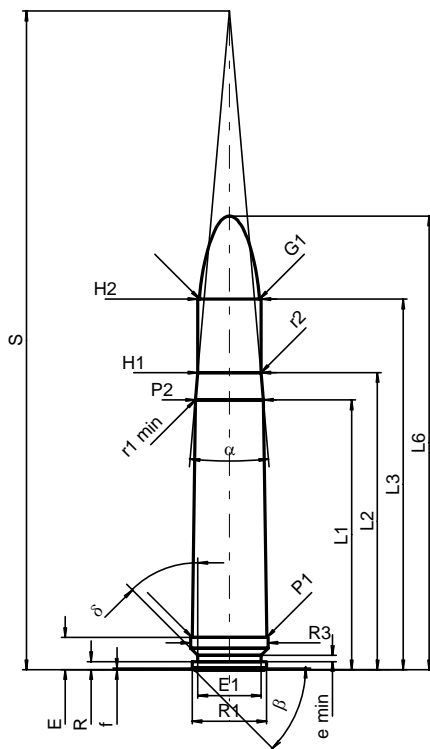
**CARTOUCHE MAXI****Longueurs**

L1	=	53.50
L2	=	58.93
L3 ¹⁾	=	73.50
L4	=	
L5	=	
L6	=	90.00

Culot

R	=	1.60
R1	=	14.71
R3	=	15.33
E ¹⁾	=	6.40
E1	=	12.57
e min	=	1.24
delta	=	45°
f	=	0.30
beta	=	45°

Chambre à poudre

P1 ¹⁾	=	14.78
P2*	=	13.50

Cône de raccordement

alpha*	=	9°59'55"
S*	=	130.66
r1 min	=	0.50
r2	=	0.50

Collet

H1*	=	12.55
H2 ¹⁾	=	12.55

Projectile

G1 ^{1)*}	=	11.89
G2	=	
F	=	
L3+G ¹⁾	=	83.27

Pressions (Énergies)**Méthode transducteur**

Pmax	=	4300 bar
PK	=	4945 bar
PE	=	5375 bar
M	=	25.00
EE	=	8300 Joule

Autres indications

Fe ¹⁾	=	0.10
delta L	=	

CHAMBRE MINI**Longueurs**

L1	=	53.28
L2	=	58.65
L3 ¹⁾	=	73.80

Cuvette

R	=	1.60
R1	=	15.39
R2	=	
R3	=	15.39
r	=	

Chambre à poudre

E ¹⁾	=	6.43
P1 ¹⁾	=	14.81
P2*	=	13.53

Cône de raccordement

alpha*	=	10°00'14"
S*	=	130.57
r1 max	=	0.50
r2	=	0.50

Collet

H1*	=	12.59
H2 ¹⁾	=	12.58

Prise de rayures

G1 ^{1)*}	=	11.90
G ¹⁾	=	9.77
alpha1	=	90°
h	=	0.34
s*	=	5.00
i ^{1)*}	=	1°26'28"
w	=	

Canon

F ^{1)*}	=	11.66
Z ¹⁾	=	11.89

Rayures

b	=	3.25
N	=	8
u	=	356.00
Q	=	109.81 mm ²

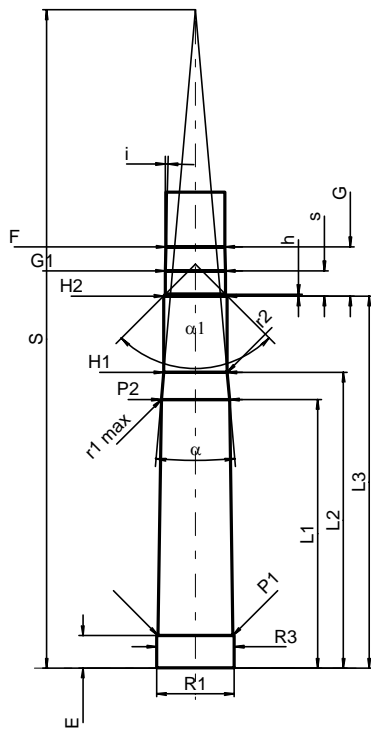

Échelle 1:1.5

Dimensions en << mm >>
Dimensions et tolérances pour les canons
d'épreuve: Voyez Annexe CR 1.

Notes: 1) A contrôler pour la sécurité
* Dimensions de base