

C.I.P.**338 Win. Mag.**

TAB. III

Date 84-06-14

Révision 02-05-15

Pays d'origine: US

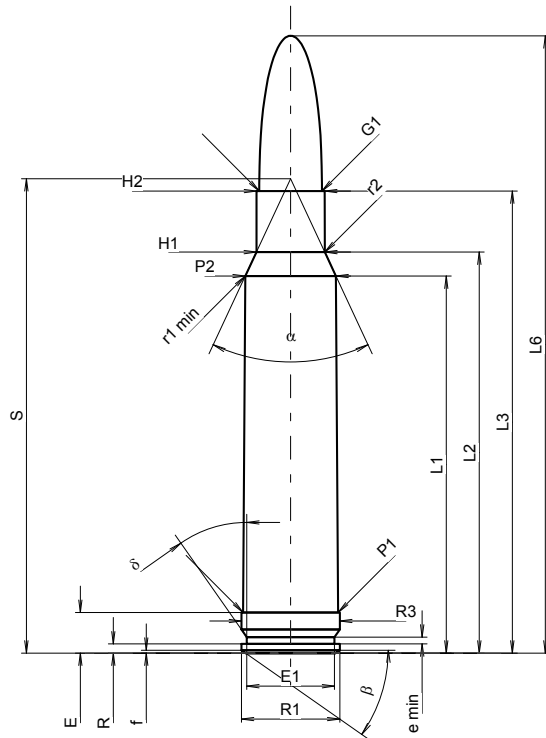
**CARTOUCHE MAXI****Longueurs**

L1	=	51.82
L2	=	55.11
L3 ¹⁾	=	63.50
L4	=	
L5	=	69.85
L6	=	84.84

Culot

R	=	1.27
R1	=	13.51
R3	=	13.51
E ¹⁾	=	5.59
E1	=	12.07
e min	=	0.94
delta	=	35°
f	=	0.41
beta	=	35°

Chambre à poudre

P1	=	13.03
P2 *	=	12.47

Cône de raccordement

alpha *	=	50°
S *	=	65.19
r1 min	=	1.02
r2	=	3.18

Collet

H1 *	=	9.40
H2 ¹⁾	=	9.37

Projectile

G1 ¹⁾	=	8.61
G2	=	8.38
F	=	
L3+G ¹⁾	=	69.27

Pressions (Énergies)**Méthode transducteur**

Pmax	=	4300 bar
PK	=	4945 bar
PE	=	5375 bar
M	=	25.00
EE	=	5460 Joule

Autres indications

Fe ¹⁾	=	0.10
delta L	=	

CHAMBRE MINI**Longueurs**

L1	=	52.02
L2	=	55.30
L3 ¹⁾	=	64.11

Cuvette

R	=	
R1	=	13.59
R2	=	
R3	=	13.59
r	=	

Chambre à poudre

E ¹⁾	=	5.59
P1 ¹⁾	=	13.06
P2 *	=	12.50

Cône de raccordement

alpha *	=	50°
S *	=	65.42
r1 max	=	0.76
r2	=	3.81

Collet

H1 *	=	9.44
H2 ¹⁾	=	9.41

Prise de rayures

G1 ¹⁾ *	=	8.76
G ¹⁾	=	5.77
alpha1 *	=	90°
h	=	0.33
s	=	
i ¹⁾ *	=	2°
w	=	

Canon

F ¹⁾ *	=	8.38
Z ¹⁾	=	8.59

Rayures

b	=	2.79
N	=	6
u	=	254.00
Q	=	56.95 mm ²

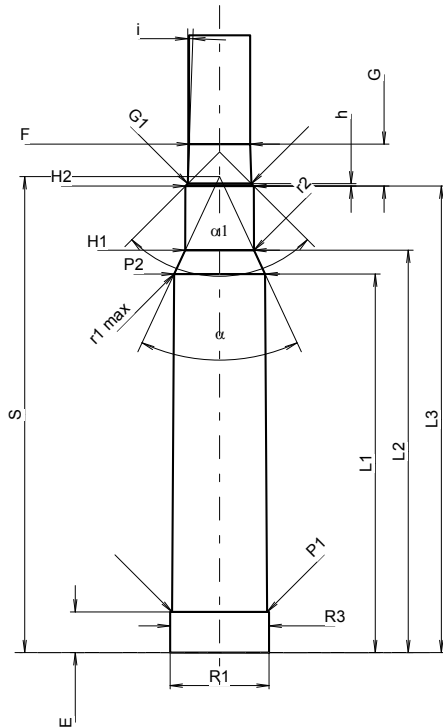

Échelle 1:1.04

Dimensions en << mm >>
Dimensions et tolérances pour les canons
d'épreuve: Voyez Annexe CR 1.

Notes: 1) A' contrôler pour la sécurité
* Dimensions de base