

C.I.P.**600 N.E.**

TAB.

II

Date

84-06-14

Pays d'origine: GB

Révision

02-05-15

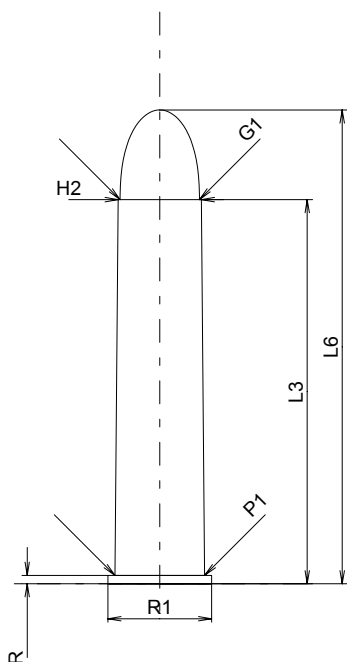
**CARTOUCHE MAXI****Longueurs**

L1	=	
L2	=	
L3 ¹⁾	=	76.20
L4	=	
L5	=	
L6	=	93.98

Culot

R ¹⁾	=	1.65	-0.25
R1	=	20.57	
R3	=		
E	=		
E1	=		
e min	=		
δ	=		
f	=		
β	=		

Chambre à poudre

P1	=	17.78
P2	=	

Cône de raccordement

α	=	
S	=	
r1 min	=	
r2	=	

Collet

H1	=	
H2 ¹⁾	=	16.51

Projectile

G1 ¹⁾	=	15.75
G2	=	
F	=	
L3+G ¹⁾	=	86.89

Pressions (Énergies)**Méthode transducteur**

Pmax	=	2450 bar
PK	=	2818 bar
PE	=	3060 bar
M	=	25.00
EE	=	10323 Joule

Autres indications

Fe ¹⁾	=	0.15
delta L	=	

CHAMBRE MINI**Longueurs**

L1	=	
L2	=	
L3 ¹⁾	=	76.45

Cuvette

R ¹⁾	=	1.68
R1	=	20.83
R2	=	
R3	=	
r	=	

Chambre à poudre

E	=	
P1 ¹⁾	=	17.81
P2	=	

Cône de raccordement

α	=	
S	=	
r1 max	=	
r2	=	

Collet

H1	=	
H2 ¹⁾	=	16.54

Prise de rayures

G1 ^{1)*}	=	15.78
G ^{1)*}	=	10.69
α1	=	90°
h*	=	0.38
s	=	
i ¹⁾	=	1°05'01"
w	=	

Canon

F ^{1)*}	=	15.39
Z ¹⁾	=	15.70

Rayures

b	=	4.09
N	=	7
u	=	762.00
Q	=	190.51 mm ²

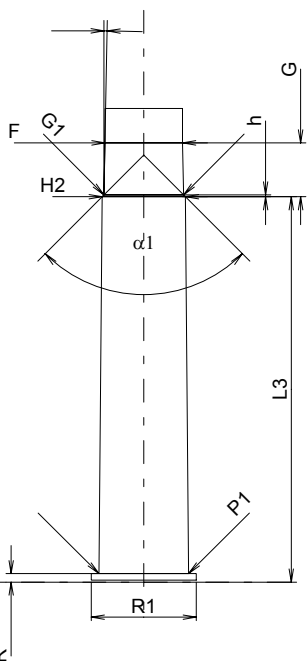

Échelle 1:1.5

Dimensions en << mm >>
Dimensions et tolérances pour les canons
d'épreuve: Voyez Annexe CR 1.

Notes: 1) A' contrôler pour la sécurité
* Dimensions de base