

C.I.P.**500 N. E. 3"**

TAB.

II

Date

84-06-14

Révision

05-07-20

Pays d'origine: GB

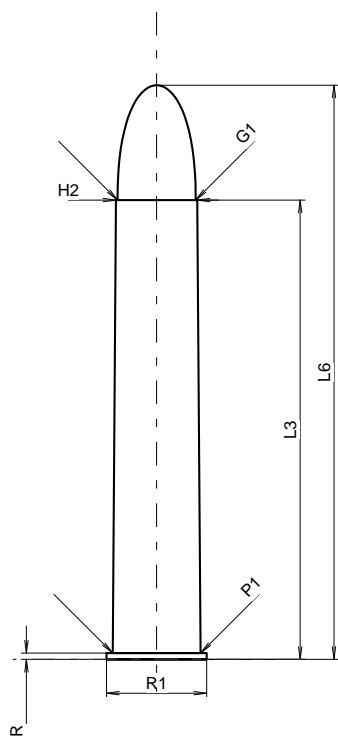
**CARTOUCHE MAXI****Longueurs**

L1	=	
L2	=	
L3 ¹⁾	=	76.20
L4	=	
L5	=	
L6	=	95.25

Culot

R ¹⁾	=	1.02	-0.25
R1	=	16.64	
R3	=		
E	=		
E1	=		
e min	=		
δ	=		
f	=		
β	=		

Chambre à poudre

P1	=	14.58
P2	=	

Cône de raccordement

α	=	
S	=	
r1 min	=	
r2	=	

Collet

H1	=	
H2 ¹⁾	=	13.51

Projectile

G1 ¹⁾	=	12.95
G2	=	
F	=	
L3+G ¹⁾	=	86.02

Pressions (Énergies)**Méthode transducteur**

Pmax	=	2800 bar
PK	=	3220 bar
PE	=	3500 bar
M	=	25.00
EE	=	8400 Joule

Autres indications

Fe ¹⁾	=	0.15
delta L	=	

CHAMBRE MINI**Longueurs**

L1	=	
L2	=	
L3 ¹⁾	=	76.45

Cuvette

R ¹⁾	=	1.04
R1	=	16.89
R2	=	
R3	=	
r	=	

Chambre à poudre

E	=	
P1 ¹⁾	=	14.61
P2	=	

Cône de raccordement

α	=	
S	=	
r1 max	=	
r2	=	

Collet

H1	=	
H2 ¹⁾	=	13.54

Prise de rayures

G1 ¹⁾ *	=	13.00
G ¹⁾ *	=	9.82
α1	=	90°
h*	=	0.27
s	=	
i ¹⁾	=	0°53'58"
w	=	

Canon

F ¹⁾ *	=	12.70
Z ¹⁾	=	13.00

Rayures

b	=	3.61
N	=	7
u	=	381.00
Q	=	130.52 mm ²

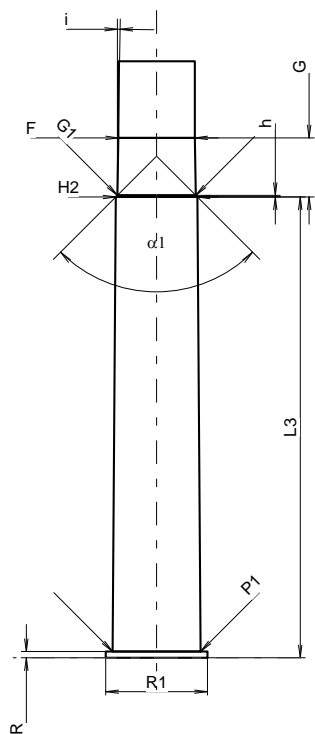

Échelle 1:1.25

Dimensions en << mm >>
Dimensions et tolérances pour les canons
d'épreuve: Voyez Annexe CR 1.

Notes: 1) A' contrôler pour la sécurité
* Dimensions de base