

C.I.P.**500 Al Sharqi**

TAB.

II

Date

21-11-09

Pays d'origine: DE

Révision

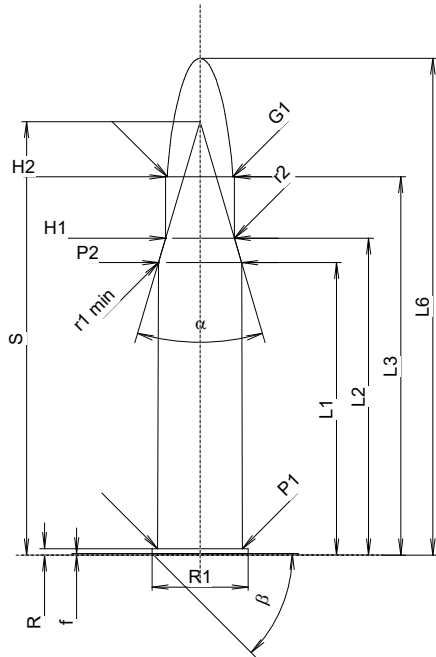
**CARTOUCHE MAXI****Longueurs**

L1	=	58.00
L2	=	62.83
L3 ¹⁾	=	75.00
L4	=	
L5	=	
L6	=	98.50

Culot

R ¹⁾	=	1.27	-0.25
R1	=	19.05	
R3	=		
E	=		
E1	=		
e min	=		
delta	=	0°	
f	=	0.30	
beta	=	45°	

Chambre à poudre

P1	=	16.81
P2 *	=	16.50

Cône de raccordement

alpha *	=	32°52'
S *	=	85.96
r1 min	=	0.50
r2	=	0.50

Collet

H1 *	=	13.65
H2 ¹⁾	=	13.65

Projectile

G1 ¹⁾ *	=	12.95
G2	=	
F	=	
L3+G ¹⁾	=	84.89

Pressions (Énergies)**Méthode transducteur**

Pmax	=	3000 bar
PK	=	3450 bar
PE	=	3750 bar
M	=	25.00
EE	=	10000 Joule

Autres indications

Fe ¹⁾⁴⁾	=	0.15
delta L	=	

CHAMBRE MINI**Longueurs**

L1	=	58.05
L2	=	62.83
L3 ¹⁾	=	75.30

Cuvette

R	=	1.27
R1	=	19.10
R2	=	
R3	=	
r	=	

Chambre à poudre

E	=	
P1 ¹⁾	=	16.84
P2 *	=	16.53

Cône de raccordement

alpha *	=	33°
S *	=	85.97
r1 max	=	0.50
r2	=	0.50

Collet

H1 *	=	13.70
H2 ¹⁾	=	13.68

Prise de rayures

G1 ¹⁾ *	=	13.00
G ¹⁾	=	9.89
alpha1	=	90°
h *	=	0.34
s	=	
i ¹⁾ *	=	0°53'59"
w	=	

Canon

F ¹⁾ *	=	12.70
Z ¹⁾	=	13.00

Rayures

b	=	3.20
N	=	8
u	=	381.00
Q	=	130.56 mm ²

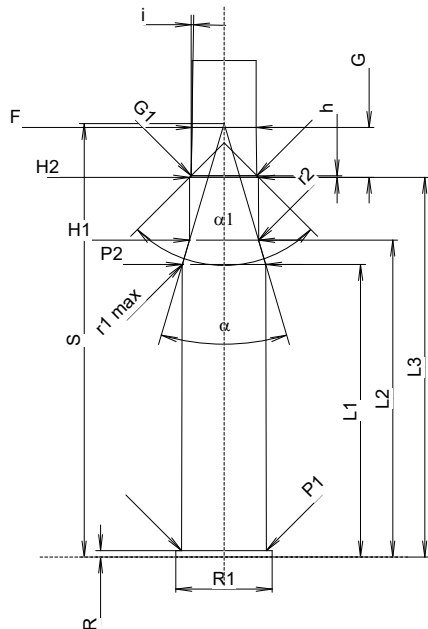

Échelle 1:1.5

Dimensions en << mm >>
Dimensions et tolérances pour les canons
d'épreuve: Voyez Annexe CR1.

Notes: 1) A' contrôler pour la sécurité
4) Feuilleure sur la bourrelet
* Dimensions de base