

C.I.P.**400 Purdey 3"**

TAB. II

Date 84-06-14

Pays d'origine: GB

Révision 07-05-14

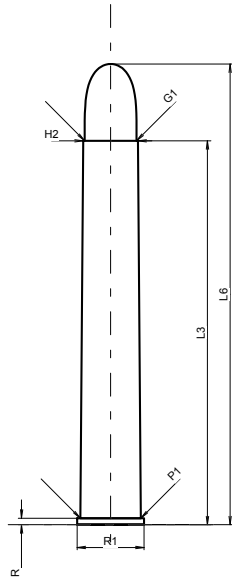
**CARTOUCHE MAXI****Longueurs**

L1	=	
L2	=	
L3 ¹⁾	=	76.20
L4	=	
L5	=	
L6	=	91.44

Culot

R ¹⁾	=	1.32
R1	=	13.26
R3	=	
E	=	
E1	=	
e min	=	
δ	=	
f	=	
β	=	

Chambre à poudre

P1	=	11.99
P2	=	

Cône de raccordement

α	=	
S	=	
r1 min	=	
r2	=	

Collet

H1	=	
H2 ¹⁾	=	10.85

Projectile

G1 ¹⁾	=	10.29
G2	=	
F	=	
L3+G ¹⁾	=	86.36

Pressions (Énergies)**Méthode transducteur**

Pmax	=	2400 bar
PK	=	2760 bar
PE	=	3000 bar
M	=	25.00
EE	=	3300 Joule

Autres indications

Fe ¹⁾⁴⁾	=	0.15
delta L	=	

CHAMBRE MINI**Longueurs**

L1	=	
L2	=	
L3 ¹⁾	=	76.45

Cuvette

R ¹⁾	=	1.35
R1	=	13.51
R2	=	
R3	=	
r	=	

Chambre à poudre

E	=	
P1 ¹⁾	=	12.01
P2	=	

Cône de raccordement

α	=	
S	=	
r1 max	=	
r2	=	

Collet

H1	=	
H2 ¹⁾	=	10.87

Prise de rayures

G1 ¹⁾ *	=	10.33
G ¹⁾	=	10.16
α1 *	=	90°
h	=	0.27
s	=	5.08
i ¹⁾ *	=	1°24'34"
w	=	

Canon

F ¹⁾ *	=	10.08
Z ¹⁾	=	10.33

Rayures

b	=	3.56
N	=	7
u	=	381.00
Q	=	82.98 mm ²

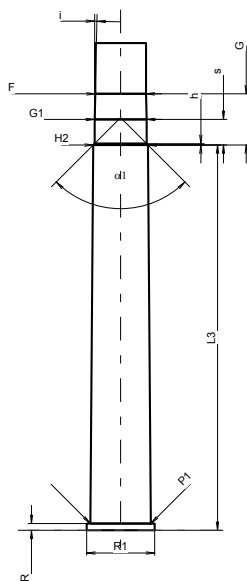

Échelle 1:1.5

Dimensions en << mm >>
Dimensions et tolérances pour les canons
d'épreuve: Voyez Annexe .

Notes: 1) A' contrôler pour la sécurité
4) Feuiliure sur la bourrelet
* Dimensions de base