

C.I.P.**32 Win. Spec.**

TAB.

II

Date

84-06-14

Pays d'origine: US

Révision

02-05-15

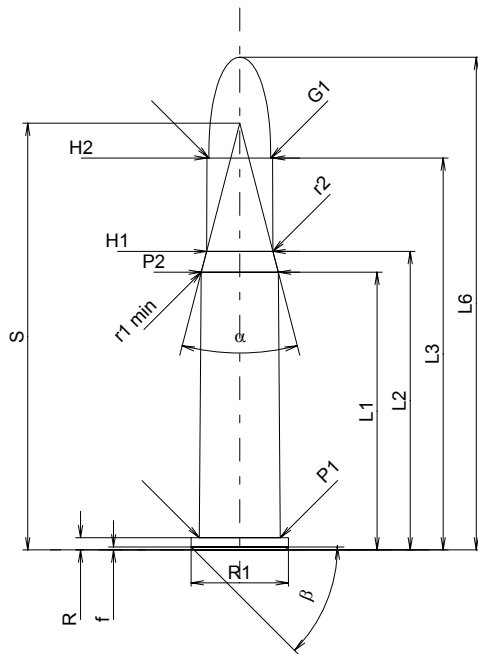
**CARTOUCHE MAXI****Longueurs**

L1	=	36.72
L2	=	39.47
L3 ¹⁾	=	51.82
L4	=	
L5	=	
L6	=	65.15

Culot

R ¹⁾	=	1.60	-0.25
R1	=	12.85	
R3	=		
E	=		
E1	=		
e min	=		
δ	=		
f	=	0.38	
β	=	45°	

Chambre à poudre

P1	=	10.72
P2*	=	10.20

Cône de raccordement

α*	=	29°01'59"
S*	=	56.42
r1 min	=	3.81
r2	=	7.62

Collet

H1*	=	8.78
H2 ¹⁾	=	8.71

Projectile

G1 ¹⁾	=	8.18
G2	=	
F	=	
L3+G ¹⁾	=	53.16

Pressions (Énergies)**Méthode transducteur**

Pmax	=	3050 bar
PK	=	3508 bar
PE	=	3810 bar
M	=	25.00
EE	=	2370 Joule

Autres indications

Fe ¹⁾	=	0.15
delta L	=	

CHAMBRE MINI**Longueurs**

L1	=	36.82
L2	=	39.56
L3 ¹⁾	=	52.91

Cuvette

R ¹⁾	=	1.60
R1	=	13.11
R2	=	
R3	=	
r	=	

Chambre à poudre

E	=	
P1 ¹⁾	=	10.74
P2*	=	10.24

Cône de raccordement

α*	=	29°28'01"
S*	=	56.29
r1 max	=	3.81
r2	=	7.62

Collet

H1*	=	8.80
H2 ¹⁾	=	8.72

Prise de rayures

G1 ¹⁾ *	=	8.72
G ¹⁾	=	1.34
α1*	=	180°
h	=	
s	=	
i ¹⁾ *	=	15°
w	=	

Canon

F ¹⁾ *	=	8.00
Z ¹⁾	=	8.13

Rayures

b	=	2.69
N	=	6
u	=	406.00
Q	=	51.33 mm ²

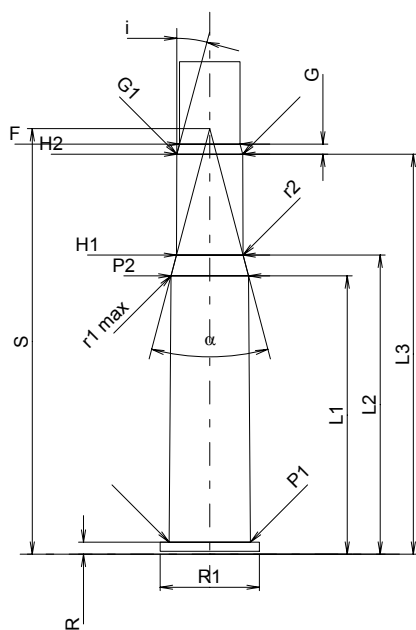

Échelle 1:1

Dimensions en << mm >>
Dimensions et tolérances pour les canons
d'épreuve: Voyez Annexe CR 1.

Notes: 1) A' contrôler pour la sécurité
* Dimensions de base