

C.I.P.**8 x 51 (Mauser K)**

TAB. I

Date 84-06-14

Pays d'origine: DE

Révision 02-05-15

CARTOUCHE MAXI**CHAMBRE MINI****Longueurs**

L1 ^{1)*}	=	38.09	-0.20
L2 ^{1)*}	=	42.16	-0.20
L3 ¹⁾	=	50.70	
L4	=		
L5	=		
L6	=	68.00	

Longueurs

L1 [*]	=	38.04
L2 [*]	=	42.09
L3 ¹⁾	=	51.00

Culot

R	=	1.30
R1	=	11.95
R3	=	
E	=	3.20
E1	=	10.50
e min	=	0.90
δ	=	36°
f	=	0.30
β	=	45°

Cuvette

R	=	1.30
R1	=	12.00
R2	=	
R3	=	
r	=	

Chambre à poudre

P1	=	11.95
P2 ^{1)*}	=	11.15 -0.20

Chambre à poudre

E	=	3.20
P1 ¹⁾	=	11.98
P2 [*]	=	11.18

Cône de raccordement

α	=	29°59'08"
S	=	58.91
r1 min	=	0.50
r2	=	0.50

Cône de raccordement

α ¹⁾	=	29°59'42"
S	=	58.91
r1 max	=	0.50
r2	=	0.50

Collet

H1 [*]	=	8.97
H2 ¹⁾	=	8.97

Collet

H1 [*]	=	9.01
H2 ¹⁾	=	9.00

Projectile

G1 ¹⁾	=	8.07
G2	=	
F	=	
L3+G ¹⁾	=	85.70

Prise de rayures

G1 ^{1)*}	=	8.15
G ^{1)*}	=	35.00
α1	=	180°
h	=	
s	=	
i ¹⁾	=	0°17'11"
w	=	

Pressions (Énergies)**Méthode transducteur**

Pmax	=	3400 bar
PK	=	3910 bar
PE	=	4250 bar
M	=	25.00
EE	=	2635 Joule

Canon

F ^{1)*}	=	7.80
Z ¹⁾	=	8.07

Rayures

b	=	4.40
N	=	4
u	=	240.00
Q	=	50.30 mm ²

Autres indications

Fe ¹⁾	=	0.15
delta L	=	

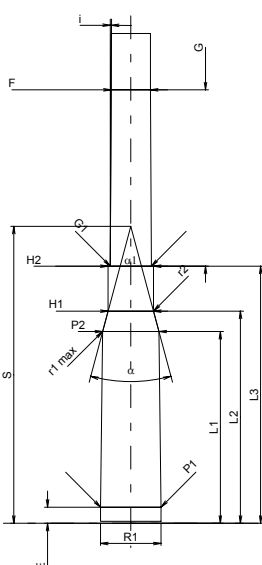
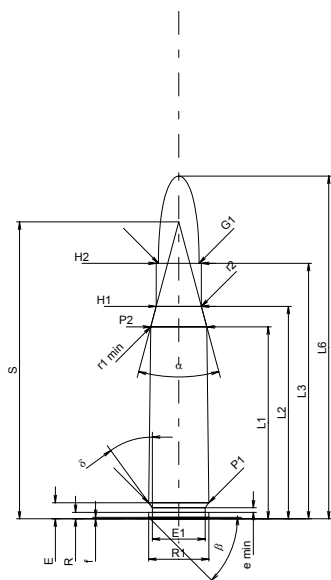

Échelle 1:1.5

Dimensions en << mm >>
Dimensions et tolérances pour les canons
d'épreuve: Voyez Annexe CR 1.

Notes: 1) A' contrôler pour la sécurité
* Dimensions de base