

C.I.P.**7,62 UKM**

Pays d'origine: DE

TAB.

I

Date

02-01-22

Révision

08-09-23

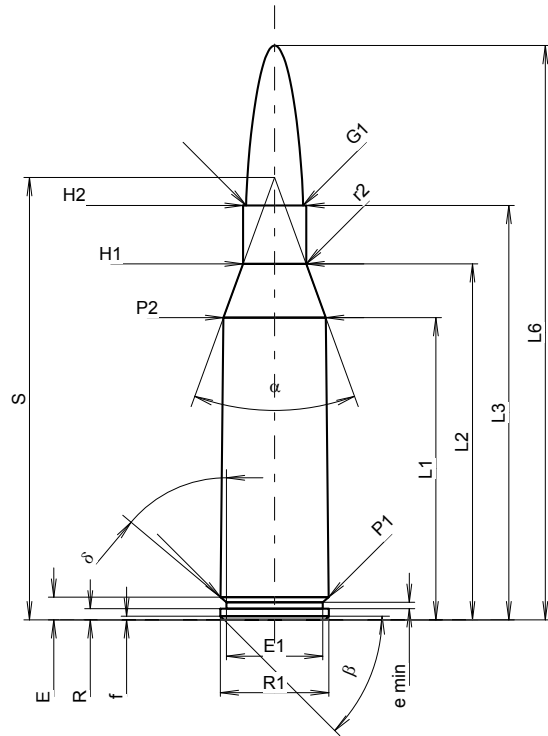
**CARTOUCHE MAXI****Longueurs**

L1 ^{1)*}	=	41.57	-0.20
L2 ^{1)*}	=	48.96	-0.20
L3 ¹⁾	=	57.00	
L4	=		
L5	=		
L6	=	79.00	

Culot

R	=	1.52	
R1	=	14.93	
R3	=		
E	=	3.12	
E1	=	13.24	
e min	=	0.90	
δ	=	50°01'33"	
f	=	0.50	
β	=	45°	

Chambre à poudre

P1	=	14.91	
P2 ^{1)*}	=	14.08	-0.20

Cône de raccordement

α	=	40°08'26"	
S	=	60.84	
r1 min	=		
r2	=	2.00	

Collet

H1 *	=	8.68	
H2 ¹⁾	=	8.68	

Projectile

G1 ¹⁾	=	7.85	
G2	=		
F	=		
L3+G ¹⁾	=	64.89	

Pressions (Énergies)**Méthode transducteur**

Pmax	=	4400 bar	
PK	=	5060 bar	
PE	=	5500 bar	
M	=	25.00	
EE	=	5565 Joule	

Autres indications

Fe ¹⁾³⁾	=	0.10	
delta L	=		

CHAMBRE MINI**Longueurs**

L1 *	=	41.50	
L2 *	=	48.93	
L3 ¹⁾	=	57.20	

Cuvette

R	=		
R1	=	15.03	
R2	=		
R3	=		
r	=		

Chambre à poudre

E	=	3.12	
P1 ¹⁾	=	14.96	
P2 *	=	14.13	

Cône de raccordement

α ¹⁾	=	40°00'33"	
S	=	60.91	
r1 max	=		
r2	=	2.50	

Collet

H1 *	=	8.72	
H2 ¹⁾	=	8.70	

Prise de rayures

G1 ^{1)*}	=	7.85	
G ^{1)*}	=	7.89	
α1	=	45°	
h	=	1.03	
s *	=	3.50	
i ¹⁾	=	1°30'02"	
w	=		

Canon

F ^{1)*}	=	7.62	
Z ¹⁾	=	7.82	

Rayures

b	=	2.79	
N	=	6	
u	=	254.00	
Q	=	47.32	mm ²

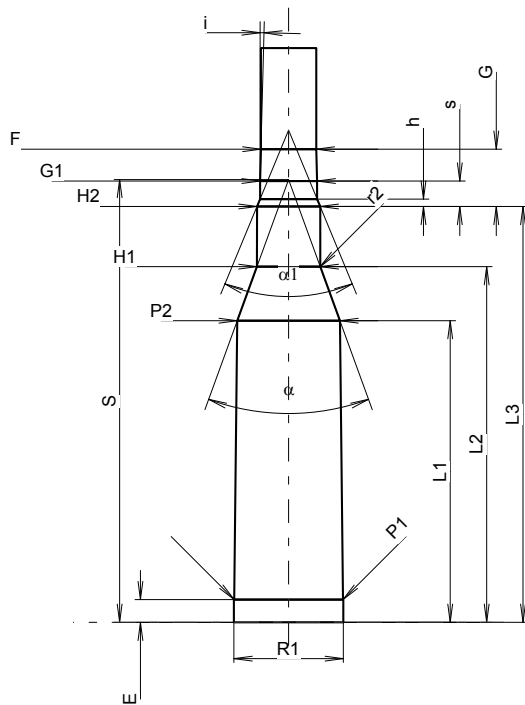

Échelle 1:1.04

Dimensions en << mm >>
Dimensions et tolérances pour les canons
d'épreuve: Voyez Annexe CR 1.

Notes: 1) A' contrôler pour la sécurité
3) Feuillure sur la cone de raccordement
* Dimensions de base