

C.I.P.**300 RCM**

Pays d'origine: US

TAB.

I

Date

10-05-26

Révision

11-05-25

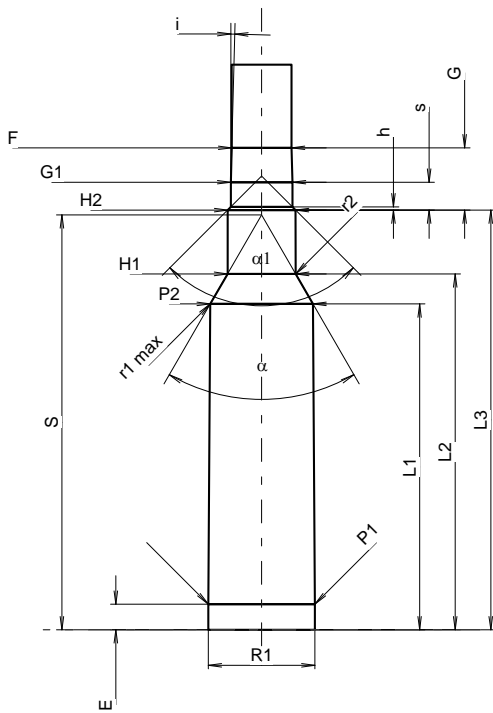
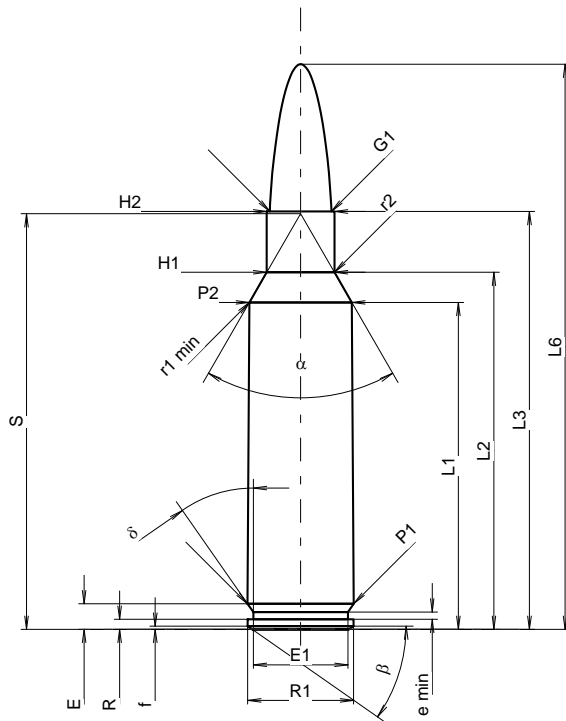

Échelle 1.04:1

CARTOUCHE MAXI**Longueurs**

L1 ¹⁾	=	41.74	-0.20
L2 ¹⁾	=	45.58	-0.20
L3 ¹⁾	=	53.34	
L4	=		
L5	=		
L6	=	72.14	

Culot

R	=	1.27	
R1	=	13.51	
R3	=		
E	=	3.27	
E1	=	12.07	
e min	=	0.94	
delta	=	35°	
f	=	0.41	
beta	=	35°	

Chambre à poudre

P1	=	13.55	
P2 ¹⁾ *	=	13.08	-0.20

Cône de raccordement

alpha *	=	60°	
S *	=	53.06	
r1 min	=	1.27	
r2	=	3.18	

Collet

H1 *	=	8.64	
H2 ¹⁾	=	8.64	

Projectile

G1 ¹⁾ *	=	7.85	
G2	=		
F	=		
L3+G ¹⁾	=	61.29	

Pressions (Énergies)**Méthode transducteur**

Pmax	=	4400 bar	
PK	=	5060 bar	
PE	=	5500 bar	
M	=	25.00	
EE	=	4900 Joule	

Autres indications

Fe ¹⁾³⁾	=	0.10	
delta L	=	0.10	

CHAMBRE MINI**Longueurs**

L1	=	41.61	
L2	=	45.44	
L3 ¹⁾	=	53.59	

Cuvette

R	=		
R1	=	13.62	
R2	=		
R3	=		
r	=		

Chambre à poudre

E	=	3.27	
P1 ¹⁾	=	13.62	
P2 *	=	13.11	

Cône de raccordement

alpha ¹⁾ *	=	60°	
S *	=	52.97	
r1 max	=	0.76	
r2	=	3.18	

Collet

H1 *	=	8.69	
H2 ¹⁾	=	8.66	

Prise de rayures

G1 ¹⁾ *	=	7.85	
G ¹⁾	=	7.95	
alpha l	=	90°	
h	=	0.41	
s	=	3.56	
i ¹⁾ *	=	1°30'	
w	=		

Canon

F ¹⁾ *	=	7.62	
Z ¹⁾	=	7.82	

Rayures

b	=	2.79	
N	=	6	
u	=	254.00	
Q	=	47.32	mm ²

Dimensions en << mm >>
Dimensions et tolérances pour les canons
d'épreuve: Voyez Annexe CR 1.

Notes: 1) A' contrôler pour la sécurité
3) Feuillure sur la cone de raccordement
* Dimensions de base