

C.I.P.**300 Blacktornado**

TAB.

I

Date

15-05-19

Révision

16-05-18

Pays d'origine: IT

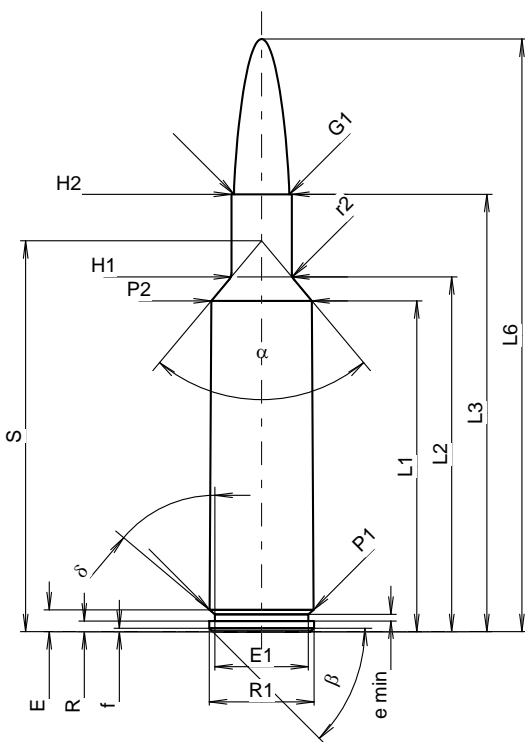
**CARTOUCHE MAXI****Longueurs**

L1 ¹⁾	=	46.90	-0.20
L2 ¹⁾	=	50.30	-0.20
L3 ¹⁾	=	62.00	
L4	=		
L5	=		
L6	=	84.00	

Culot

R	=	1.52	
R1	=	14.85	
R3	=		
E	=	3.10	
E1	=	13.24	
e min	=	0.95	
delta	=	50°	
f	=	0.50	
beta	=	45°	

Chambre à poudre

P1	=	14.74	
P2 ¹⁾ *	=	14.26	-0.20

Cône de raccordement

alpha [*]	=	80°	
S [*]	=	55.41	
r1 min	=		
r2	=	1.52	

Collet

H1 [*]	=	8.56	
H2 ¹⁾	=	8.56	

Projectile

G1	=	7.83	
G2	=		
F	=		
L3+G ¹⁾	=	68.11	

Pressions (Énergies)**Méthode transducteur**

Pmax	=	4400 bar	
PK	=	5060 bar	
PE	=	5500 bar	
M	=	25.00	
EE	=	5220 Joule	

Autres indications

Fe ¹⁾³⁾	=	0.10	
delta L	=		

CHAMBRE MINI**Longueurs**

L1	=	46.99	
L2	=	50.38	
L3 ¹⁾	=	62.23	

Cuvette

R	=		
R1	=	14.90	
R2	=		
R3	=		
r	=		

Chambre à poudre

E	=	3.15	
P1 ¹⁾	=	14.86	
P2 [*]	=	14.30	

Cône de raccordement

alpha ¹⁾ *	=	80°	
S [*]	=	55.51	
r1 max	=		
r2	=	1.52	

Collet

H1 [*]	=	8.61	
H2 ¹⁾	=	8.61	

Prise de rayures

G1 ¹⁾ *	=	7.84	
G ¹⁾	=	6.11	
alpha 1	=	90°	
h	=	0.39	
s [*]	=	1.91	
i ¹⁾ *	=	1°30'	
w	=		

Canon

F ¹⁾ *	=	7.62	
Z ¹⁾	=	7.82	

Rayures

b	=	4.47	
N	=	4	
u	=	229.00	
Q	=	47.51	mm ²

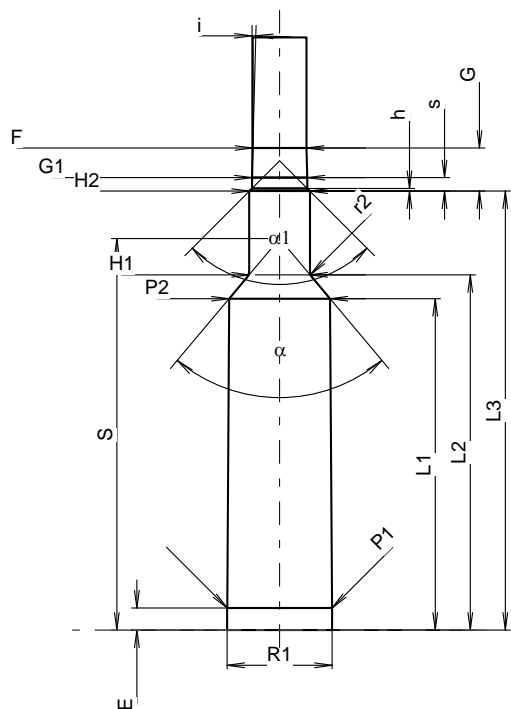

Échelle 1:1.07

Dimensions en << mm >>
Dimensions et tolérances pour les canons
d'épreuve: Voyez Annexe CR1.

Notes: 1) A' contrôler pour la sécurité
3) Feuillure sur la cone de raccordement
* Dimensions de base